



Elos Accurate® Analog for Printed Models

Instruction for Use

Disclaimer of liability Elos Medtech Pinol products may only be used according to the instructions and recommendations. The user of Elos Medtech Pinols products should determine their suitability for particular patients and indications. Elos Medtech Pinol disclaims any liability, expressed or implied, and shall have no responsibility for any direct, indirect, punitive or damages arising out of or in connection with any errors in professional judgement or practice in the use or placement of the Elos Medtech Pinol products.



Elos Medtech Pinol A/S
Engvej 33
DK-3330 Gørløse
www.elosmedtech.com

Document ID: DEV-01204 version 2.0

Contents

Instruction for use - English	3
-------------------------------------	---

Instruction for use - English

Elos Accurate® Analog for Printed Models

1. Intended use

The Elos Accurate® Analog for Printed Models is a dental implant replica intended to be mounted in a dental laboratory working model in order to duplicate the location and restorative platform orientation of the final dental implant.

2. Product Description

The product consists of the Elos Accurate® Analog for Printed Models (Analog) manufactured in the biocompatible material titanium alloy grade 5 ELI (TiAl₆V₄ ELI).

3. Products accessory

Elos Accurate® Analog Pliers & Elos Accurate® Analog Insertion Pin

The Elos Accurate® Analog Pliers (Pliers) and Elos Accurate® Analog Insertion Pin (Pin) provided by Elos Medtech Pinol A/S must be used to fixate the Analog in the dental laboratory working model.

Elos Accurate® Analog Insertion Screw

In case of a loose fit due to inaccurate printing the optional Elos Accurate® Analog Insertion Screw (Screw) can be mounted in the Analog by using the screwdriver interface at the end of the Pliers. This will help secure firm positioning of the Analog in the dental laboratory working model.

The Pliers, Pin and Screw are compatible to all the variants of the Analogs.

4. Indications

- The Analog is intended for dental laboratory use only.
- The Analog is compatible with dental laboratory working models manufactured by additive 3D printing only.

5. Contraindications

- None

6. Warnings and precautions

- The Analog may only be used with a compatible digital library file installed in the design software.
- The Analog is for single-use only.
- Reuse of the Analog can result in loss of functionality.
- The Analog, Insertion Pin, Pliers or Screw must never be changed or modified.
- The Analog, Insertion Pin, Pliers and Screw must only be used and handled by dental professionals.
- The torque applied to a screw for tightening a component (e.g. abutment) placed into the Analog must not exceed the recommended torque defined by the original component manufacturer.
- The torque applied to Screw must not exceed 5 Ncm.

7. Compatibility information

The Analog is available for a variety of implant platforms and sizes. The individual product label refers to which implant platform and size the Analog is compatible to.

8. Printer and print material

Elos Medtech Pinol A/S has verified the Analog in dental laboratory working models printed with an accuracy of $\pm 0.05\text{mm}$. To achieve appropriate restoration results, dental laboratory working models must be printed within at least the same accuracy and in a suitable material.

9. Procedure

Elos Accurate® Libraries for design software can be downloaded from: www.elosdental.com.

1. Place the Insertion Pin in the dental laboratory working model from underneath.

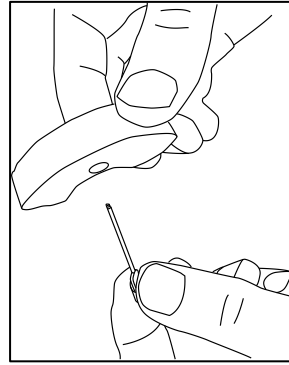

2. Screw the Analog onto the Insertion Pin by hand (max. 5Ncm)

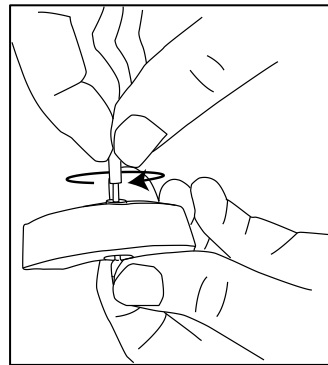

3. Pull down and rotate clockwise the Insertion Pin until the Analog is rotational fixated in the dental laboratory working model (one position only).

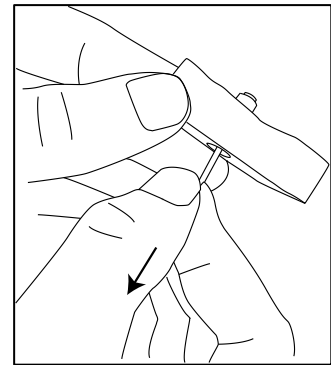
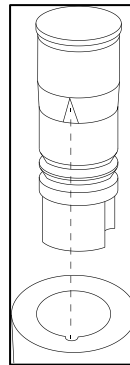

4. Slide the groove of the Pliers onto the Insertion Pin until the Pliers rest on the Insertion Pin and in the dental laboratory working model. Rotate the Pliers 90 degrees according to the Insertion Pin.

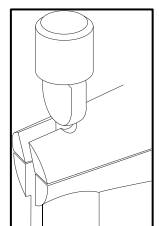
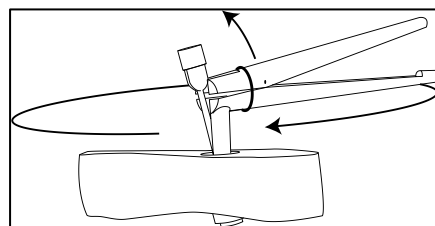

5. Apply compression force to the handle of the Pliers until the Analog is pulled into position.

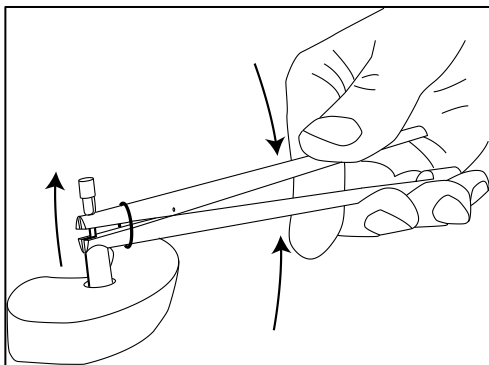

6. The Screw can be mounted in the Analog by using the screwdriver interface at the end of the Pliers.

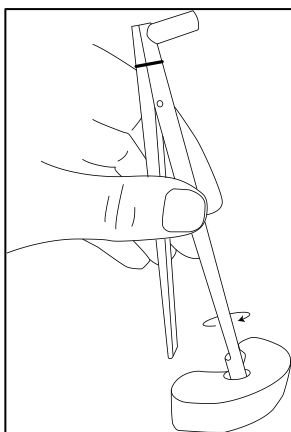

10. Further information

For additional information about the use of Elos Medtech products, please contact your local sales representative.

11. Validity

Upon publication of this instruction for use, all previous versions are superseded.

12. Storage and Handling

The Analog, Insertion Pin, Pliers and Screw should be stored at room temperature.

13. Caution

U.S. Federal Law restricts this device to sale by or on order of a licensed dentist or physician.

14. Disposal

The Analog, Insertion Pin, Pliers and Screw must be disposed of according to local country regulations.

15. Signs and symbols



Catalogue number



Batch code



Manufacturer



Consult instructions for use



Do not re-use



Prescription only



Do not use if package is damaged